

BAUHAUS-MUSEUM WEIMAR



In April 2019 the Klassik Stiftung Weimar will open the new Bauhaus Museum. It will focus on the early Bauhaus that was founded in Weimar in 1919 and stayed there until 1925.

Minimally self-confident

Minimalist and yet self-confident: With its clear geometry and generously designed front plaza, the new building invites visitors to come inside and stay awhile. The design by Heike Hanada in cooperation with Benedict Tonon opens up views to the inside and to the outside, and, with its cleverly designed surroundings it corresponds with the adjacent Weimarhallenpark. Together with the Neues Museum and the exhibition on forced labor during National Socialism, a new museum quarter has emerged.

Illuminated

The new building is a geometrically clear-cut cube with five levels and can be entered from the side facing the city through a generous foyer area. From the side facing the Weimarhallenpark, one crosses a large terrace before entering the building. At night, it will be illuminated, giving the entire area a new, bright center.

Design Icons and Sensual Experiences

The exhibition will offer an adequate presentation format for one of the most important Bauhaus collections in the country and the oldest Bauhaus holdings in the world, for which Walter Gropius himself selected the core objects. The Klassik Stiftung Weimar holds 13,000 objects and documents in its collection, including the Ludwig Collection on design history from the 18th to the 20th century. Particularly precious objects include the famous Wagenfeld lamp, the lattice chair by Marcel Breuer, the teapot by Marianne Brandt, ceramics by Theodor Bogler, as well as works by Paul Klee, Peter Keler and László Moholy-Nagy. The exhibition focusses on the design icons, but also on documents of the period that have never been shown before.

Along with the permanent exhibition, the museum will also offer temporary exhibits and a comprehensive accompanying program. Not only the historic Bauhaus avant-garde can be experienced, but also today's designers, artists and architects. "There are many sensual experiences for visitors – in the stage room for example, or workshop experience in bookbinding as it was done during the Bauhaus period, or even 3D-printing," Ulrike Bestgen, the director

Information

OPENING HOURS

Monday 9.00 am - 2.30 pm

Tue - Sun 9.00 - 6pm

Advance booking for the next day only. The pre-sale takes place exclusively in the museum and in the kiosk at Stéphane-Hessel-Platz.

ADDRESS

Bauhaus-Museum
Stéphane-Hessel-Platz 1
99423 Weimar

Fon: 03643 / 54 54 00

Fax: 03643 - 41 98 16

✉ E-Mail

🌐 Website

📍 show map

♿ BARRIEREFREIHEIT

MORE ABOUT THE BAUHAUS

➔ Bauhaus Sites in Weimar

of the bauhaus museum weimar explains. The museum complies with the pedagogical and life-styling principles of the Weimar Bauhaus, creating striking visual impressions and intuitive accessibility.

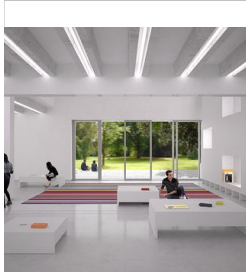

bauhaus museum weimar

The Klassik Stiftung Weimar owns one of the most important Bauhaus collections comprising over 10,000 objects from the early period of the school. In order to present this collection appropriately, the Klassik Stiftung Weimar is building a new building to house the Bauhaus Museum, to be completed by April 2019.

➤ [more about the bauhaus museum weimar](#)

Anzeigen